

# Fire exit

## Fire Stopping Solutions



firas



## H.A. Marks - Fire Stopping Solutions

FIRAS approved, audited and 3rd Party Accredited **Fire Stopping / Penetration Sealing Specialists**.

FIRAS approved, audited and 3rd Party Accredited installers of **Fire Door Sets**.

- Replacement of Fire Doors
- Penetration sealing
- Surveys and repairs of existing compartmentation
- Upgrading Existing Fire Doors
- Fire Rated Wall Panelling
- Fire Stopping to walls and floors
- Intumescent Spraying to Steels



## Fire Doors - Upgrade or New Installations

H.A. has achieved FIRAS registration for upgrading works to existing fire doors to current regulations. Together with our specialist consultant surveying partners, we offer full surveys/reports, scheduling repairs required along with remediation & upgrade works to make existing fire doors compliant.

## Intumescent Spraying of Structural Steel Work

H.A. Marks have a certified specialist coatings partner to apply intumescent coatings to structural steelwork. This is a tried and tested way of protecting buildings.

### What is intumescent paint?

Intumescent paints are specialist coatings that provide up to 120 minutes fire protection on structural steel. The paint reacts to high temperatures, typically above 200 C, by expanding up to 50 times its original thickness. This increase in volume and decrease in density provides insulation to the structural steel members against high temperatures and acts to delay or prevent structural failure in the event of a fire. Available as water based and solvent based coatings, intumescent paints are quick to apply and provide a smooth and durable decorative finish to structural steelwork in both internal and external locations.

## Fire Rated Wall Panelling

Our insulated panels are a reliable choice wherever fireproof materials are required to protect life and property. The insulated panels system provides a complete solution for fire resistant facilities or interiors, with non-combustible panels and specially designed details and accessories.

Our insulated panels are non-combustible, classified in Euroclass A2-s1,d0 and our structural stone wool core is in Euroclass A1. PAROC panel structures meet the requirements for fire resistance up to four hours in walls and up to one hour in ceilings.

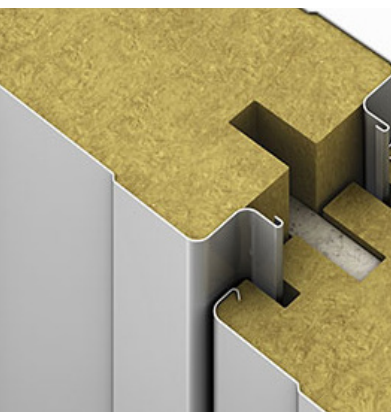

## State of the Art 'iFireAudit' Software System

H.A. Marks have invested in providing our clients with a fully traceable cloud based software system to trace, repair and record works to include before, during and after picture evidence, which can then be plotted on the precise location plotted on drawings which will generate a unique ID code for that particular fire stop installation. A report may be generated to issue to the client following repairs or new fire stopping which will give the client an audit trail and record of works undertaken.

## Landsec Securities

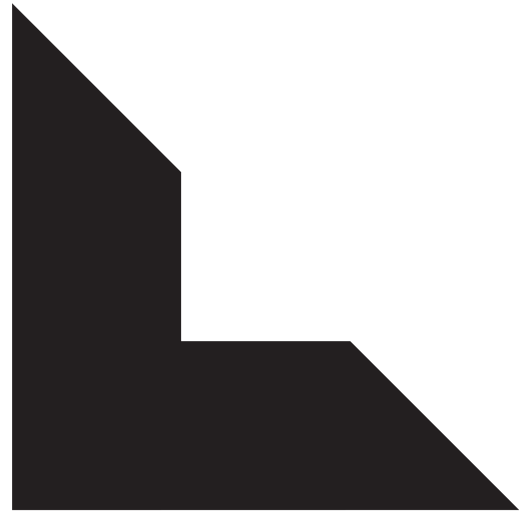

# Landsec

H.A. Marks Ltd were awarded the contract to undertake remedial Fire-Stopping across the Landsec portfolio at various sites. The properties are a mix of commercial offices, residential buildings, including hotels and mixed use occupancy. These sites were high profile buildings which required careful planning to avoid disruption to occupants. The works were carried out during Normal and Out of hours to meet the clients requirements working around the day to day building operations at each site.



## Endeavour Academy



Endeavour Academy is a specialist school and children's home in Oxford for children and young people aged between 8 and 19 with autism and severe learning difficulties who benefit from an autism specific environment. This project required a very high level of management and close liaison to ensure the continued smooth running of the school.

Working very closely with the client, H.A. Marks carried out Fire Compartmentation Works.

### **Compartmentation works consisted of:**

- *Passive Fire Stopping and remedial works in school buildings and accommodation block*
- *Install new Fire Doors*
- *New Wall Lining Works*
- *New Flooring*
- *Electrical Works*
- *New Fire Rated Ceilings and Wall Panelling*

Works were carefully programmed and carried out in occupation with a high level of liaison and protection.

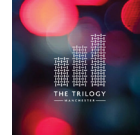

## The Trilogy, Manchester



The Trilogy

H.A. Marks was awarded the contract to carry out the Fire Stopping, including all fire compartmentation requirements to the new build structure.

**Compartmentation works consisted of:**

*Passive Fire Stopping and remedial works in Communal Areas & Apartments.*



## 72-82 Gaskarth Road



H.A. Marks have completed some social housing works for Wandsworth Borough Council (WBC) in existing housing areas, where access was restricted, and site areas small. This development is another example of Wandsworth Council's "long-standing commitment to building new homes through making more efficient use of land on the borough's housing estates."

Wandsworth Council engaged H.A. Marks to Design & Build a traditional scheme of 6 x 2 bed Flats for rent in Clapham, South London. The scheme included 2 x 2 bed disabled flats on the ground floor with sun terraces and balconies.

**Works consisted of:**

- 2 x 2 Bed, 3 Person DDA ground floor - 69m<sup>2</sup> (flats 1&2)
- 2 x 2 Bed, 3 Person first floor - 67m<sup>2</sup> (flats 3&4)
- 2 x 1 Bed, 2 Person second floor - 60m<sup>2</sup> (flats 5&6)

*Gaskarth Road is a traditional road with Victorian style houses and the scheme was designed to mirror this Victorian terraced appearance. A traditional build, with traditional brick, the scheme was designed in robust detail and built to 'Code 4 Sustainable Homes' with photovoltaic panels on the roof.*

A key restriction on the build was the very tight access with limited space for welfare and storage but we overcame this through making local off-site arrangements and having a footpath closure. The project was under the NHBC and Considerate Constructors schemes and inspected throughout.

## Thames Reach Nursery



**Client:** Leyf Nurseries

**Location:** Battery Road, Thames Reach, London, SE28 0NY

This was a full refurbishment and fit out of a ground floor vacant retail unit to create a multi-use infant's nursery with staff facilities, 3 large education rooms and an outdoor education space.

**Fire protection works carried out:**

- Installation of passive fire protection to electrical and mechanical systems
- Installation of internal fire doors to give 30-minute and 60-minute protection



## Ordnance Mews (numbers 10, 11 & 12)



**Client:** Westminster Council

**Location:** St Johns Wood, London NW8 6PF

3 bedroom, 2 bathroom, timber frame townhouses with terraces.

Working in partnership with Westminster Council on their MMC projects, to utilise any unused or dilapidated spaces to create new homes where possible. We demolished a row of condemned and unsafe garages creating space for 3 family townhouses in an area in much need of larger affordable homes. Each house had 3 bedrooms, 2 bathrooms, a large open plan kitchen/living area and an external terrace.

**Fire protection works carried out:**

- *Installation of passive fire protection to electrical and mechanical systems*
- *Internal fire rated partitions and soffits to timber frame*
- *Installation of internal fire doors*

## Melrose & Keith



**Client:** Westminster Council

**Location:** St Johns Wood, London NW8 6PF

A project in partnership with Westminster Council, turning dilapidated land, or areas that are currently not being utilised into more affordable homes for residents. Two projects in Maida Vale and one in St Johns Wood to create a total of 15 new council properties, ranging from 1 bed flats to 3-bedroom family homes.

**Associated fire protection works:**

- *Passive fire stopping to all services within properties.*
- *Fire rated partitions to protect timber frame structure.*
- *Installation of fire doors, both external and internal*



## Helmsdale House



**Client:** Westminster Council

**Location:** St Johns Wood, London NW8 6PF

A project in partnership with Westminster Council, turning dilapidated land, or areas that are currently not being utilised into more affordable homes for residents. Two projects in Maida Vale and one in St Johns Wood to create a total of 15 new council properties, ranging from 1 bed flats to 3-bedroom family homes.

**Associated fire protection works:**

- *Passive fire stopping to all services within properties*
- *Fire rated partitions to protect timber frame structure*
- *Installation of fire doors, both external and internal*



## Ockendon



**Client:** C2C Rail

**Location:** Ockendon Station

H.A. Marks operating in partnership with C2C rail franchise to deliver a large-scale station refurbishment project across the majority of their operating route, major works were carried out as part of this project at Grays and Ockendon station to refurbish ticket halls, ticket offices, staff canteens and customer and staff washroom facilities.

**Fire protection works included:**

- Fire stopping to required services
- Installation of new timber fire doors
- Installation of new steel fire doors

## Grays Stations



Grays Stations

**Client:** C2C Rail

**Location:** Grays Station

H.A. Marks operating in partnership with C2C rail franchise to delivery a large-scale station refurbishment project across the majority of their operating route, major works were carried out as part of this project at Grays and Ockendon station to refurbish ticket halls, ticket offices, staff canteens and customer and staff washroom facilities.

**Fire protection works included:**

- *Fire stopping to required services*
- *Installation of new timber fire doors*
- *Installation of new steel fire doors*

Corrib House, 1 Beadman Street, London, SE27 0DN

**Tel:** 0208 659 6918 **Email:** mail@hamarks.com [www.hamarks.com](http://www.hamarks.com)

